



# Official copy of register of title

Title number K944978

Edition date 02.09.2008

- This official copy shows the entries in the register of title on 2 September 2008 at 08:50:49.
- This date must be quoted as the "search from date" in any official search application based on this copy.
- The date at the beginning of an entry is the date on which the entry was made in the register.
- Issued on 2 September 2008.
- Under s.67 of the Land Registration Act 2002, this copy is admissible in evidence to the same extent as the original.
- For information about the register of title see Land Registry website [www.landregistry.gov.uk](http://www.landregistry.gov.uk) or Land Registry Public Guide 1 - *A guide to the information we keep and how you can obtain it*.
- This title is dealt with by Land Registry Tunbridge Wells Office.

## A: Property register

This register describes the land and estate comprised in the title.

KENT : SHEPWAY

- 1 (02.09.2008) The Freehold land shown edged with red on the plan of the above title filed at the Registry and being Palmarsh Recreation Ground, Burmarsh Road, Hythe.

## B: Proprietorship register

This register specifies the class of title and identifies the owner. It contains any entries that affect the right of disposal.

### Title absolute

- 1 (02.09.2008) PROPRIETOR: HYTHE TOWN COUNCIL of Town Clerks Offices, Council Offices, Hythe, Kent CT21 6BG.
- 2 (02.09.2008) The value as at 2 September 2008 was stated to be under £50,000.

## End of register

Land Registry  
Official copy of  
title plan

Title number **K944978**  
Ordnance Survey map reference **TR1333NW**  
Scale **1:2500** reduced from 1:1250  
Administrative area **Kent: Shepway**

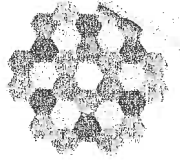

© Crown Copyright. Produced by Land Registry. Reproduction in whole or in part is prohibited without the prior written permission of Ordnance Survey. Licence Number 100026316.

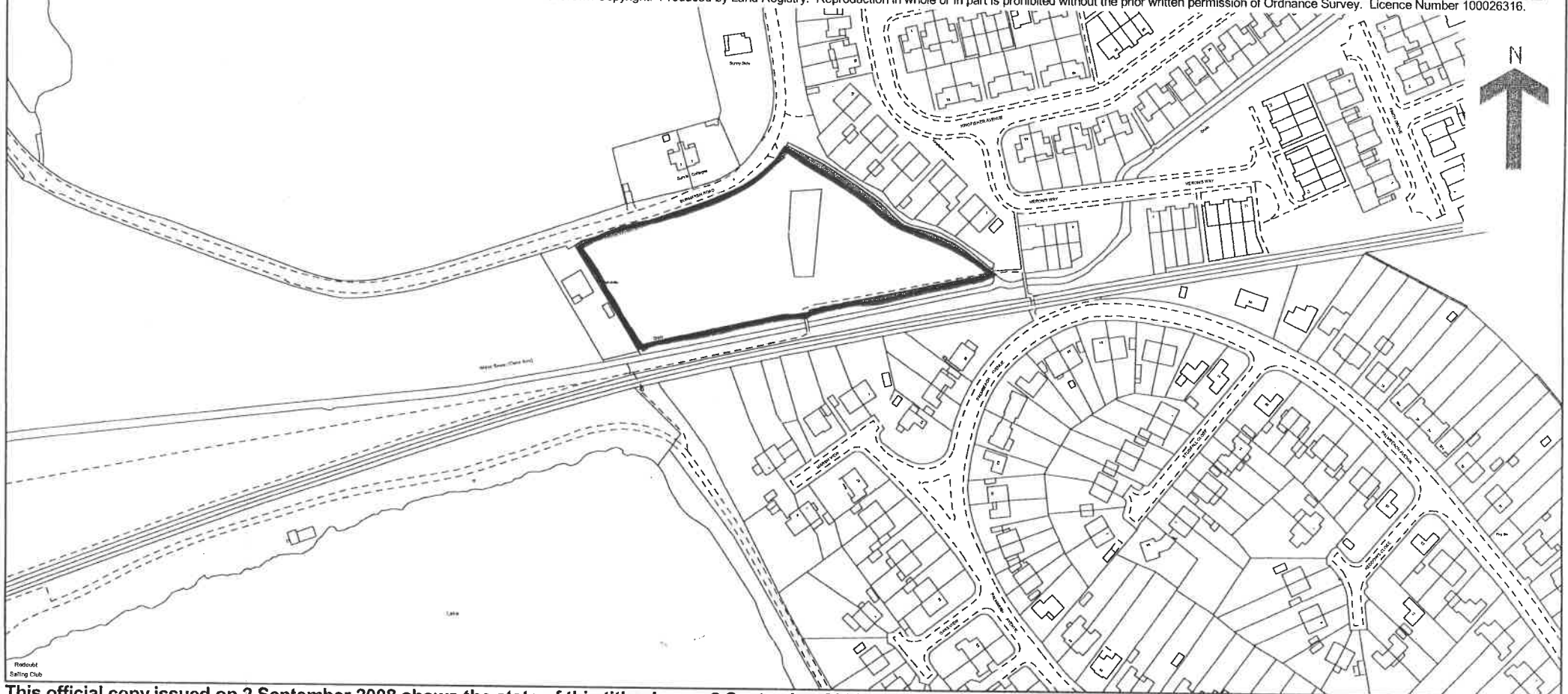

This official copy issued on 2 September 2008 shows the state of this title plan on 2 September 2008 at 08:50:49. It is admissible in evidence to the same extent as the original (s.67 Land Registration Act 2002).

This title plan shows the general position, not the exact line, of the boundaries. It may be subject to distortions in scale. Measurements scaled from this plan may not match measurements between the same points on the ground. See Land Registry Public Guide 19 - Title Plans and Boundaries.

This title is dealt with by Land Registry, Tunbridge Wells Office.