



Official copy of register of title

Title number K945878

Edition date 23.09.2008

- This official copy shows the entries in the register of title on 23 September 2008 at 13:51:08.
- This date must be quoted as the "search from date" in any official search application based on this copy.
- The date at the beginning of an entry is the date on which the entry was made in the register.
- Issued on 23 September 2008.
- Under s.67 of the Land Registration Act 2002, this copy is admissible in evidence to the same extent as the original.
- For information about the register of title see Land Registry website www.landregistry.gov.uk or Land Registry Public Guide 1 - *A guide to the information we keep and how you can obtain it.*
- This title is dealt with by Land Registry Tunbridge Wells Office.

A: Property register

This register describes the land and estate comprised in the title.

KENT : SHEPWAY

- 1 (23.09.2008) The Freehold land shown edged with red on the plan of the above title filed at the Registry and being The Green, St Leonards Road, Hythe.

B: Proprietorship register

This register specifies the class of title and identifies the owner. It contains any entries that affect the right of disposal.

Title absolute

- 1 (23.09.2008) PROPRIETOR: HYTHE TOWN COUNCIL of Town Clerks Offices, Council Offices, Hythe, Kent CT21 6BG.
- 2 (23.09.2008) The value as at 23 September 2008 was stated to be under £50,000.

C: Charges register

This register contains any charges and other matters that affect the land.

- 1 (23.09.2008) Restrictive covenants created by a deed dated 26 June 1972 made between (1) The Mayor Aldermen and Burgesses of the Borough of Hythe

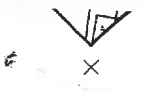

C: Charges register continued

and (2) South Eastern Gas Board but neither the original nor a certified copy or examined abstract of it was produced on first registration.

NOTE: This information was taken from a Land Charge Class D(ii) dated 5 July 1972 reference number 255145.

- 2 (23.09.2008) Restrictive covenants created by a deed dated 27 March 1974 made between (1) The Mayor Aldermen and Burgesses of the Borough of Hythe and (2) British Gas corporation but neither the original nor a certified copy or examined abstract of it was produced on first registration.

NOTE: This information was taken from a Land Charge Class D(ii) dated 14 May 1974 reference number 124948.

- 3 (23.09.2008) Restrictive covenants created by a deed dated 6 December 1991 made between (1) The Town and Cinque Port of Hythe and (2) British Gas PLC but neither the original nor a certified copy or examined abstract of it was produced on first registration.

NOTE: This information was taken from a Land Charge Class D(ii) dated 13 December 1991 reference number 147622.

- 4 (23.09.2008) The land is subject to the rights granted by a Deed of Grant dated 20 June 1995 so far as it affects the land in this title made between (1) Hythe Town Council and (2) Seeboard Plc.

NOTE: -Copy filed.

End of register

Land Registry
Official copy of
title plan

Title number **K945878**
Ordnance Survey map reference **TR1534SE**
Scale **1:2500** reduced from 1:1250
Administrative area **Kent: Shepway**

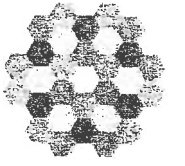

© Crown Copyright. Produced by Land Registry. Reproduction in whole or in part is prohibited without the prior written permission of Ordnance Survey. Licence Number 100026316.

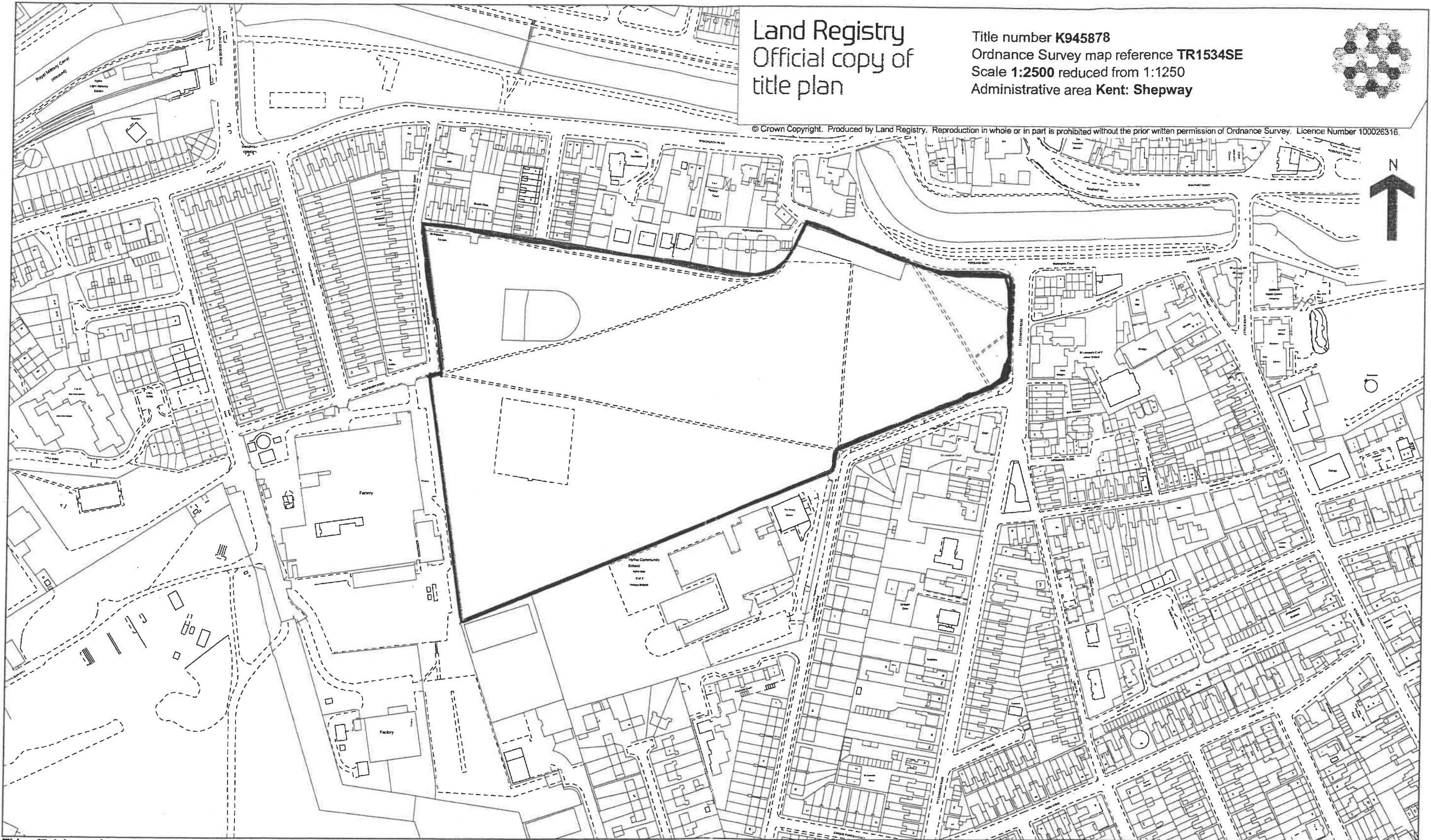

This official copy issued on 23 September 2008 shows the state of this title plan on 23 September 2008 at 13:51:08. It is admissible in evidence to the same extent as the original (s.67 Land Registration Act 2002).
This title plan shows the general position, not the exact line, of the boundaries. It may be subject to distortions in scale. Measurements scaled from this plan may not match measurements between the same points on the ground. See Land Registry Public Guide 19 - Title Plans and Boundaries.
This title is dealt with by Land Registry, Tunbridge Wells Office.