

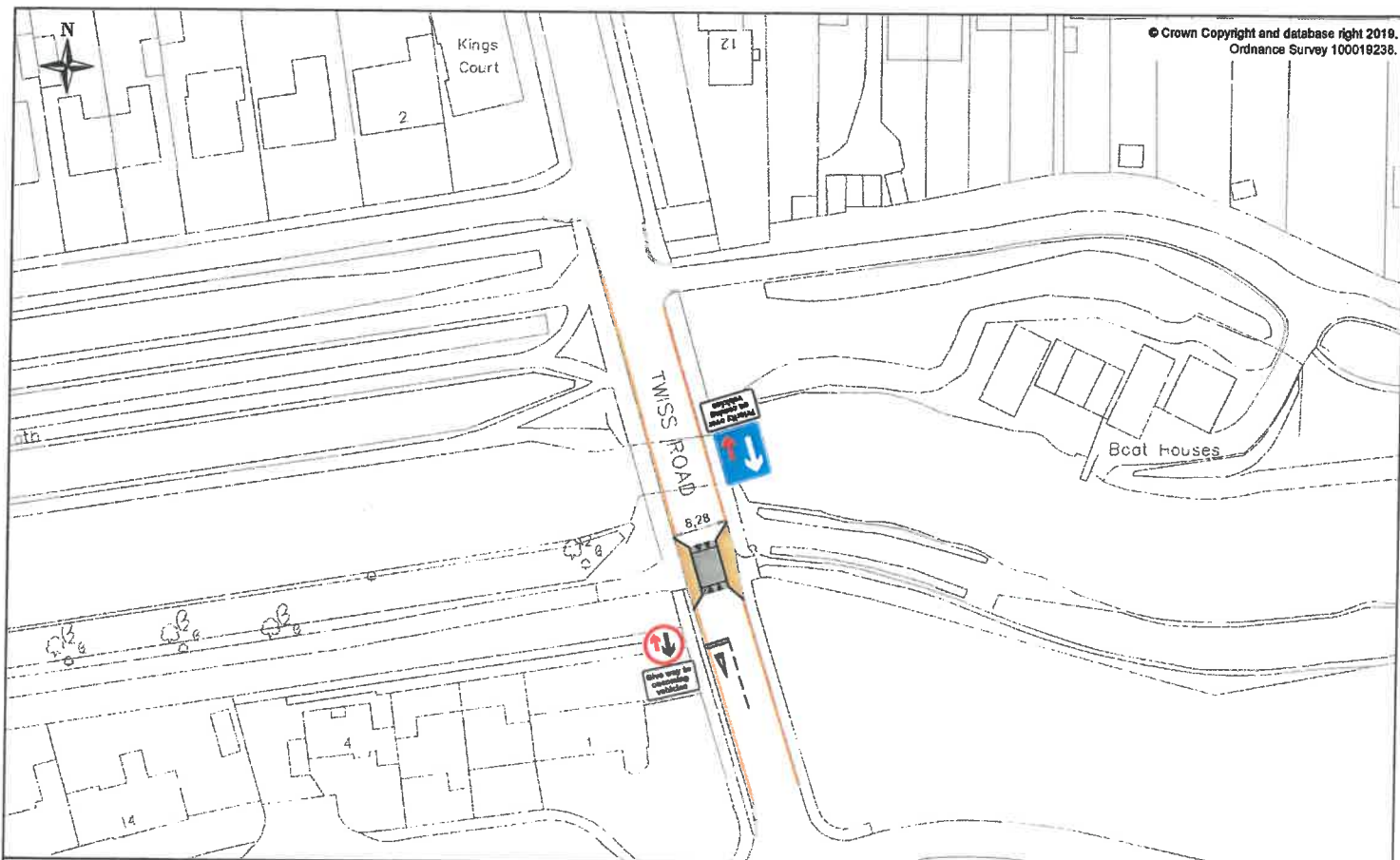

Item 11. Highway Improvement Plan

Please find attached Hythe Town Council Highway Improvement Plan. An outline design and cost estimate has been provided for both potential Twiss Road and South Road schemes.

If you would like to proceed South Street to a detailed design, then please instruct the Town Clerk to arrange for an invoice to be issued for the value of £3,000. The same applies for Twiss Road but with a value of £1,500. Once the funds have been received Kent County Council will carry out a site survey, draw up a detailed design and an associated formal quotation for the works.



 <p>Kent County Council Ashford Highway Depot Hemwood Industrial Estate Ashford TN24 8AD Tel: 03030 419181</p>			Project		TWISS ROAD, HYTHE		This drawing is not to be used in whole or part other than for the intended purpose and project as defined on this drawing. Refer to the contract for full terms and conditions.	
			Drawing title		OUTLINE DESIGN		Drawing status	
D DDMMYY Rev Revision Date Purpose of revision Drawn Check'd App'd			Scale		1:250 at A3		Do not scale	
			Drawing number		**_**_****_****		Rev	
							0	

S:\GT SP\00\kals\FH21-22 D C and Team\21-22 Parish Councils\Hythe\HPT\Twiss Road\Twiss Road\Hythe.dwg



Kent County Council		Kent County Council Roads/Highways Dept Hemmed Industrial Estate Ashford TN26 3AD Tel: 0303 418811	
SOUTH ROAD, HYTHE			
INSTALLATION OF TRAFFIC CALMING GIVE WAY PRIORITY SYSTEM AND PEDESTRIAN FOOTWAY			
OUTLINE DESIGN			
1: 1000 at A1		Do not scale	
KCC/FH/LR/SOUTH ROAD		0	

This is a preliminary drawing and is not to be used for construction. It is for information only and is subject to change without notice. It is not to be used for any other purpose without the written consent of the Kent County Council.

Matrix of Fees for TRO Application

	Consultation size	
	Small 1-30	Large over 31
1. On application (includes review of application, letter consultation to all relevant stakeholders, Notice in the newspaper, Notices on site, drafting of legal Traffic Regulation Order, review and tabling of responses).	£1385	£1965
2. No objections received or once objections overcome, progress scheme (this includes responses to objectors, Notice in the newspaper, sending off Order for legal to sign and seal and "Make" Order).	£1000	£1000
3. Report to Director of Highways Transportation and Waste or JTB.	£570	£570
4. If KCC to design and construct.	Estimate to be provided	Estimate to be provided

Hythe Highway Improvement Plan – Twiss Road, Hythe cost estimate

Items	Notes		Costs
Preparation of detailed design and implementation costs	<p>This would include:</p> <ul style="list-style-type: none"> • A Principal Designer being assigned to the project • Site survey • Statutory undertaker searches • Preparation of a Bill of Quantities (that would inform you of the actual cost of construction, should you wish to proceed). • Project management • Road safety audit Stage 2. 	<p>This would <u>not</u> include:</p> <ul style="list-style-type: none"> • Communications / engagement with the community on the proposals. • Undertaking the construction phase (this cost would be as per the Bill of Quantities) • Any costs related to the construction phase - such as labour, Traffic Management, supply and installation of materials, power supply and connections. 	£1500.00
Traffic Regulation Order for double yellow lining around priority systems.	<p>This would include:</p> <ul style="list-style-type: none"> • Consultation • Formal Notification (local press) • Sealing legal order 	<p>This would <u>not</u> include:</p> <ul style="list-style-type: none"> • If we receive 5 or more objections to the proposed double yellow lining there will be a requirement for Officers to prepare and present a report on the objections for consideration at a Folkestone & Hythe Joint Transportation Board Meeting. Should this be the case additional Officer time will be charged. 	£2965.00
Civils	<p>This would include:-</p> <ul style="list-style-type: none"> • Install new pedestrian footway, kerb build out, traffic calming priority system and speed ramp. 		£8000.00 (estimate until site survey and design carried out)

	<ul style="list-style-type: none"> • Installation of carriageway lining and associated signage. • Traffic management • Road safety audit Stage 3 • Project management 		
TOTAL			£12465.00



NB: Should complications arise and project costs look like they will exceed the estimate above, we will contact you in advance.

Hythe Highway Improvement Plan – South Street cost estimate

Items	Notes		Costs
Preparation of detailed design and implementation costs	<p>This would include:</p> <ul style="list-style-type: none"> • A Principal Designer being assigned to the project • Site survey • Statutory undertaker searches • Preparation of a Bill of Quantities (that would inform you of the actual cost of construction, should you wish to proceed). • Project management • Road safety audit Stage 2. 	<p>This would <u>not</u> include:</p> <ul style="list-style-type: none"> • Communications / engagement with the community on the proposals. • Undertaking the construction phase (this cost would be as per the Bill of Quantities) • Any costs related to the construction phase - such as labour, Traffic Management, supply and installation of materials, power supply and connections. 	£3000
Traffic Regulation Order for the installation of double yellow lining around priority systems.	<p>This would include:</p> <ul style="list-style-type: none"> • Consultation • Formal Notification (local press) • Sealing legal order 	<p>This would <u>not</u> include:</p> <ul style="list-style-type: none"> • If we receive 5 or more objections to the installation of double yellow lining, there will be a requirement for Officers to prepare and present a report on the objections for consideration at a Folkestone & Hythe Transportation Board Meeting. Should this be the case additional Officer time will be charged. 	£2965.00
Civils	<p>This would include:-</p> <ul style="list-style-type: none"> • Install new pedestrian footway kerb build outs, traffic calming and priority systems. • Installation of 		£62000.00 (estimate until site survey and design carried out)

	carriageway lining and associated signage. <ul style="list-style-type: none"> • Traffic management • Road safety audit Stage 3 • Project management 		
TOTAL			£67965.00

Parish Council - Highway Improvement Plan/Action Plan

HIGHWAY IMPROVEMENT PLAN – Stage 1		ACTION PLAN – Stage 2		
Priority	Location	Problem and suggested remedy	Cost Estimate	Funding Source
1.	Twiss Road, Hythe	<p>Poor visibility and pedestrian/cyclist safety at the bridge over the Royal Military Canal due to parked cars and excessive speeds.</p> <p>This is a popular crossing point from both the north and south footpaths along the canal and the cycle path.</p> <p>For the latter, at the bridge, there is a need for cyclists (if coming from the east) to cross from the north to the south side of the canal and vice versa if coming from the east.</p> <p>The issues at this point have been raised on a regular basis by local residents.</p>	£12465.00	TBC
				<p>03/11/21 - Scheme is at outline design, an estimated cost of £12465.00 is required to complete the detailed design and install the scheme. This price is an estimate and may vary due to additional safety improvements after a road safety audit has been completed.</p> <p>Funding required to continue the scheme through to detailed design.</p> <p> TwissRoadHythe-A3 L.pdf</p>
2.	South Road, Hythe	<p>Excessive speeds on this heavily used, straight residential road. There is one speed restriction pinch point at present. One or two additional build outs would reduce traffic speeds and aid road safety at other regularly used crossing points from footpaths across the playing area.</p> <p>There is also a lack of dedicated cycle path on the north side of the road from the sports pavilion to the junction with Twiss Road.</p> <p>As with Twiss Road, residents have</p>	£67965.00	TBC
				<p>03/11/21 - Scheme is at outline design, an estimated cost of £67965.00 is required to complete the detailed design and install the scheme. This price is an estimate and may vary due to additional safety improvements after a road safety audit has been completed.</p> <p>Funding required to continue the scheme through to detailed design.</p> <p> SouthRoadHythe-A 1.pdf</p>

Parish Council - Highway Improvement Plan/Action Plan

		regularly raised concerns about speeding on South Road, particularly of late to clarify why it was not included in the 20 mph zone.			
--	--	---	--	--	--