

This report will be made public  
on 8 April 2021

# Hythe Town Council

www.Hythe-tc.gov.uk

Report number **F&GP/41/21**

To Hythe Town Council  
Date 29 March 2022  
Status **Non-Exempt**  
Responsible officer Town Clerk and Responsible Financial Officer  
Subject **TARGET HARDENING REPORT F&GP/41/21**

**SUMMARY:** This report provides a proposal for Target Hardening the Council's assets and recommends the Committee review in accordance with good practice.

## **REASON FOR RECOMMENDATION:**

The Committee is asked to agree the recommendations set out below because; -

- a) The Council is committed to work in compliance with the Governance and Accountability for smaller authorities in England.
- b) The Council is committed to manage its financial affairs under the Financial Regulations Act.

## **RECOMMENDATIONS:**

1. To receive and note the report **F&GP/41/21**
2. To review the quotes already obtained and recommend to Council which works they wish to proceed with
3. To decide on a timeline for the works to be completed

## **INTRODUCTION**

This document contains a proposal to instruct works to protect areas of Open Space that are owned and managed by Hythe Town Council from unauthorised access.

At an extra-ordinary meeting of the Finance and General Purposes Committee on 27 May 2021, Minute no.50/21 REVIEW OF THE RECENT INCURSION ON THE GREEN.

It was

RESOLVED – That item

**2. To form a Target Hardening Working Group to review the long-term security of the Town Council's land.**

Voting

For 5 Against 0 Abstain 0. The motion was carried.

Since the above meeting a Target Hardening Working Group was formed consisting of Councillors J Martin, T Prater, K Miles, M Whybrow, J Hawkins and N Slade.

### The first working group meeting was held on 2 June 2021.

#### **It was agreed that**

1. The Working Group to carry out a review and take steps to increase security on the Green.
2. Site meetings to be held and professional advice sought on future appropriate measures where added security measures are feasible on the Green and all other Hythe Town Council sites including Burmarsh and Horn Street Recreational grounds, Eaton Lands and South Road.

It was recognised that no site can be made 100% secure and that measures must be balanced with the ability of people to access and enjoy these open spaces.

Following this meeting a Security Review was completed to identify security risks associated with the open land assets owned and managed by Hythe Town Council (Appendix A attached). This report was taken to the next Working Group meeting held on 1 October 2021.

### Target Hardening Working Group Meeting Friday 1 October 2021

#### **NEW SECURITY REVIEW REPORT 2021**

Members discussed the new review report (appendix one) in comparison to a previous report created in August 2018.

The areas under discussion were.

- Oaklands Park
- Hythe Green
- South Rd
- Burmarsh Recreational Ground
- Eaton Lands Recreational Ground
- Hornstreet Recreational Ground

It was agreed that:

Once quotes have been obtained to secure the perimeters a report to Finance and General Purposes will be submitted.

It was also **AGREED** that

1. The Town Clerk requests quotes for gates and shroud padlocks for the entrances highlighted in the report.
2. That the costs be attributed to 7800 Property Repairs and Renewals.
3. The Town Clerk requests quotes for planting of the South Road perimeter, the second access point at Burmarsh and the perimeter of Hythe Green.
4. That the costs for planting be attributed to 5003 Tree Audit and Works.

**A specification for the works based on the 2021 Survey was then drawn up as follows:**

#### **Oaklands**

- 1.) Supply and fit new high security shroud padlock. (Town Clerk to organise)

#### **Hythe Green**

- ~~1.) Install new barrier gate at Boundary Road vehicle entrance.~~
- ~~2.) Supply and fit new high security shroud padlock. *These items have been ratified at Council and the contract has been awarded to Stephen Bailey Landscaping for the amount of £2,000.*~~

- 3.) Supply and fit new barrier gate at Portland Rd car park vehicle entrance.
- 4.) Supply and fit new high security shroud padlock.

**Contractor A £2,650 (items 3 and 4)**

**Contractor B £2,795 (items 3 and 4)**

**Contractor C – No response received**

- ~~5.) Plant hedging along~~ Construct earth bund along the perimeter of the car park.
- ~~6.) Plant hedging along~~ Construct earth bund the perimeter of the Green, adjacent to Portland Road.
- ~~7.) Plant hedging along~~ Construct earth bund the perimeter of the Green, adjacent to St Leonard Road.

Plant bunds with wildflower seed.

**Contractor A £11,350**

**Contractor B £12,000 (items 5,6 and 7)**

**Contractor C – No response received**

#### **South Road Recreation Ground**

- 1.) Install new barrier gate Southern Boundary.
- 2.) Supply and fit new high security shroud padlock.
- 3.) Install new barrier gate western access.
- 4.) Supply and fit new high security shroud padlock.

- 5.) To supply and install approx. 300 metres of stock fencing to a height of 1.2 metres using horse netting and chestnut posts.

Fence to run from the pavilion up to the residential houses opposite the swimming pool along South Road. Any gaps already in fence line will be reinstated. The old fence will be removed and disposed of.

**Contractor A £11,400 (items 1-5) (item 5 only - £7,000)**

**Contractor B £12,550 (items 1-5) (item 5 only - £6,750)**

**Contractor C – No response received**

**Contractor D £4,625 (item 5 only)**

#### **Burmarsh Recreation Ground**

- 1.) Construct earth bund across existing vehicular access.
- 2.) Plant with hedging whips\*.
- 3.) Install new 6m barrier gate to replace existing timber gate.
- 4.) Fit high security shroud padlock.

**Contractor A £3,075 (items 1-4)**

**Contractor B £3,470 (items 1,3-4)**

### **Contractor C – No response received**

\*It has since been discovered that the redundant timber gate at Burmarsh Recreation Ground is in fact not redundant but is used twice a year by the Environmental Agency to dredge the Royal Military Canal. Their vehicle cannot access the park through the metal gate entrance. Therefore, a new quote has been sought to not target harden the wooden gate entrance which will allow access for the Environmental Agency and the Folkestone and Hythe District's Ground Maintenance team, but to carry out the same works at the metal gate end. A larger metal gate to be installed to replace the wooden gate to ensure secure access only. The whips although already planted have had to be removed because of this and will be replanted in the autumn once it has been decided where it is safe to do so.

### **Eaton Lands**

- 1.) Install new barrier gate at both vehicle access points.
- 2.) Supply and fit high security shroud padlocks.
- 3.) Supply and install two vehicle barriers both ends of the bridle way.
- 4.) Supply and fit new high security shroud padlocks

**Contractor A £8,800**

**Contractor B £10,000**

**Contractor C – No response received**

### **Horn Street**

New barrier gate to replace existing metal horse accessible barrier.  
High security shroud padlock.

**Contractor B £2,600**

**Contractor C £3,200**

**Contractor C – No response received**

*All Prices are correct at time of quote and are subject to change due to increase in material costs. Labour costs will remain the same.*

*It is important to note the quotes for native hedge planting along the perimeters do not cover ongoing watering, post planting care and replacement of failed or vandalised plants.*

Furthermore, several residents have contacted the Town Clerk in relation to criminal damage and anti-social behaviour along the **Deedes Close Bridleway at Eaton Lands**. The Bridlepath has always been a matter of contention, as under the road traffic act motor vehicles are prohibited to use it. Complaints have been received as to the safety to pedestrians traversing along the pathway with private vehicles and construction lorries using it as a road and as access to resident's homes. Residents have requested barriers/bollards are installed on both ends of the Bridleway, therefore restricting access to the width of 9 foot.

The above was taken to a Charities Trust Meeting in July 2021 where:  
It was

### **AGREED –**

1. To conduct a survey to improve the security of Eaton Lands Meadow from unlawful encroachment

2. To provide a feasibility study on the installation of barriers/bollards to secure both ends of the bridlepath.

**These quotes are included in the specifications that were distributed and appear in the above quotes.**

### **SUMMARY**

Officers have obtained only a few quotes for the works required, as suppliers are not responding to requests. The committee are asked to review the quotes already obtained and recommend to Council which works they wish to proceed with and decide on a timeline for the works to be completed.

### **RISK MANAGEMENT**

A summary of the perceived risk follows.

<b>Perceived Risk</b>	<b>Seriousness</b>	<b>Likelihood</b>	<b>Preventative Action</b>
The Council does not take measures to target harden the open spaces they own and manage so unauthorised encampments have easier access to the areas and the council incur legal costs to have them removed.	High	Low	The Council implements works to accessibility to the open spaces that the council own and manage to ensure accessibility is harder and deters unauthorised encampments and access to the areas.

### **CONTACT OFFICER**

If you have any queries about this report, please contact The Town Clerk.

Tel: 01303 266152 or email [Clerk@hythe-tc.gov.uk](mailto:Clerk@hythe-tc.gov.uk) prior to the meeting.

# Hythe Town Council

## Open land assets

### Security review 2021

The following report identifies security risks associated with the open land assets owned and managed by Hythe Town Council and ascertains measures that can be taken to reduce the risks of incursions.

Security risks have been split into three categories:

**Red - Critical**

(Immediate remedial work required)

**Amber - Satisfactory**

(Secure, however further work recommended to bring boundary to green status)

**Green - Secure**

(No further work recommended)

## Burmarsh Road

Burmarsh Road recreation ground is located in the Western fringes of Hythe and predominantly serves Palmarsh and Burmarsh.

The recreational ground is flanked on two sides by residential properties and the RH&D railway on another. The Northern boundary however abuts the Burmarsh road. On inspection the majority of the road boundary consisted of a thick hedge, trees and a ditch leaving two access points. The first access point is secured with a metal triangular barrier however this is only locked in place with a short length of chain and padlock and the second redundant access point is a rotten timber gate. Both access points have been flagged as red.

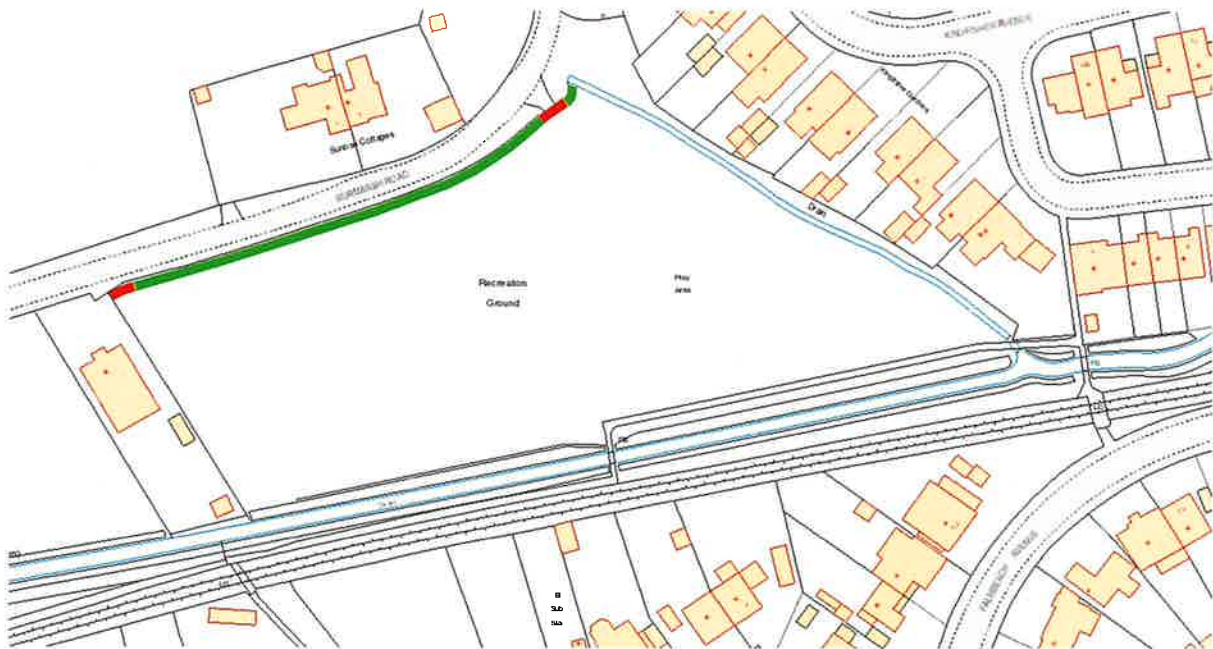

**Current estimated penetration time - 30 seconds using either vehicle or bolt croppers.**

### Recommendations

#### Redundant access point with timber gate

Construct earth bund across redundant timber gate access and plant with hedging whips, this would bring this access point to green.

#### Active access point with metal barrier

Either installing a new barrier with a shroud protecting a high security padlock or installing two sentinel posts behind existing barrier would bring the status of this access point to amber.

Installing both a new barrier with a shroud protecting a high security padlock and two sentinel posts behind the new barrier would bring this access point to green.



## Hythe Green

Hythe Green is located in the centre of Hythe and predominantly serves residents living in the centre of the town as well as hosting numerous events throughout the year.

The Northern boundary of the Green is predominately flanked by residential properties, its Southern boundary is predominately flanked by Hythe Bay School and HV Wooding's factory and its Western boundary is predominately flanked by the now redundant Sims Portex site.

On inspection the remaining boundaries exposed to road access have been protected with a simple wooden post and metal rail arrangement identified as amber.

There are three vehicular access points, one located on Boundary road, one located from the Portland Road car park and a third located on Cinque Ports Avenue.

The barrier on Boundary Road had recently been removed during a Traveller incursion and is currently protected with a simple temporary concrete bollard. The Portland Road access is a low quality pair of triangular barriers, it is secured with a padlock without a protective shroud both of these access points have been identified as red. The Cinque Ports Avenue Barrier is a heavy duty barrier secured with a security padlock protected with a shroud, this had been identified as amber.

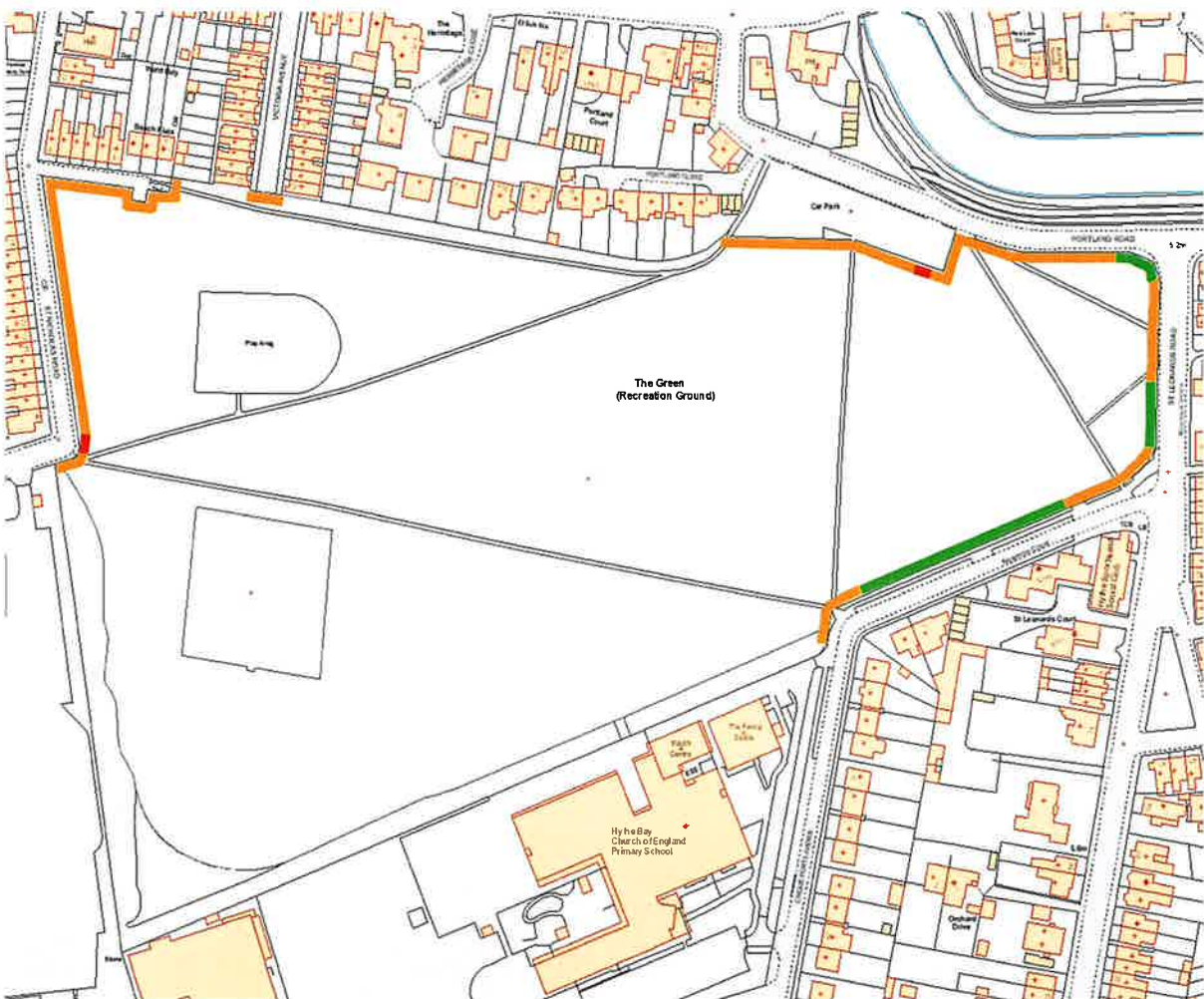

**Current estimated penetration time – 5 minutes using either vehicle or bolt croppers.**



## **Recommendations**

### Boundary Road access

Either installing a new barrier with a shroud protecting a high security padlock or installing two sentinel posts behind temporary concrete bollard would bring the status of this access point to amber.

Installing both a new barrier with a shroud protecting a high security padlock and two sentinel posts behind the new barrier would bring this access point to green.

### Portland Road car park access

Either installing a new barrier with a shroud protecting a high security padlock or installing two sentinel posts behind existing barrier would bring the status of this access point to amber.

Installing both a new barrier with a shroud protecting a high security padlock and two sentinel posts behind the new barrier would bring this access point to green.

### Cinque Ports Avenue access

Installing two sentinel posts behind existing barrier would bring the status of this access point to green.

### The boundary adjacent to St Nicholas Road and St Nicholas Terrace

Strategic tree planting in this location would bring the status of this boundary to green.

### The boundary adjacent to Portland Road Car Park

Native hedge planting along the perimeter of the car park would both screen the cars and provide another layer of security, this would bring the status of this section of boundary to green.

### The boundary adjacent to Portland Road

Construct low earth bund along this boundary and plant with wildflower s, this would bring the status of this section of boundary to green.

### The boundary adjacent to St Leonard Road

Construct low earth bund along this boundary and plant with wildflowers, this would bring the status of this section of boundary to green.

### The boundary adjacent to Cinque Ports Avenue

Strategic tree planting in this location would bring the status of this boundary to green.

## South Road recreation ground

South Road recreation ground is located in the Southern fringe of Hythe serving this area as well and hosting sporting activities for the town, predominately football.

Three of the boundaries at South Road are flanked on the western fringe by public fenced tennis courts and bowling green, on the northern fringe by a public walk way which is hedge lined and finally on the eastern fringe residential properties.

On inspection the remaining southern boundary exposed to road access is protected with a simple wooden post and metal wire arrangement identified red.

There are two vehicular access points, one located at the Eastern end of the site and the other located at the western end.

The access at the eastern point is a wooden field gate secured with an un-shrouded padlock, this point has been identified as red and the access at the western end are timber bollards secured with simple un-shrouded padlocks, this access point has been identified as amber.



**Current estimated penetration time – 1-2 minutes using either vehicle, wire cutters or a socket set.**

## **Recommendations**

### Entire southern boundary

Either installing a timber post and metal rail along the entire southern boundary as can be found on Hythe Green, or constructing a low earth bund along this boundary and planting with wildflower s would bring the status of this section of boundary to amber.

Installing both a new barrier and constructing an earth bund would bring this boundary to green.

### Western access

Either installing a new barrier with a shroud protecting a high security padlock or installing two sentinel posts behind existing barrier would bring the status of this access point to amber.

Installing both a new barrier with a shroud protecting a high security padlock and two sentinel posts behind the new barrier would bring this access point to green.

### Eastern access

Installing two sentinel posts behind the existing posts would bring this access point to green.

## Eaton Lands

Eaton Lands is located in the north of the town near the village of Saltwood, predominately serving residents in this area.

The western boundary at Eaton Lands' is predominately flanked by residential properties and its southern boundary is flanked by dense woodland and a disused quarry.

On inspection the remaining boundary exposed to road access has been protected with a very effective ditch and bund arrangement identified as green. At the eastern and western ends of the site there are simple metal post and rail arrangements which have been identified as amber. Finally there is a pedestrian access point in the middle of the site cut through the earth bund that has also been identified as amber.

There are two vehicular access points, one located at the eastern end of the site and one located at the western end of the site. Both are a metal field gate construction secured with a simple un-shrouded padlock and hinges which are not inverted. Both of these access points have been identified as red.



**Current estimated penetration time – 30 seconds using either socket set or spanner.**

## **Recommendations**

### Both vehicular access points

Either installing a new barrier with a shroud protecting a high security padlock or installing two sentinel posts behind existing gates would bring the status of these access points to amber.

Installing both a new barrier with a shroud protecting a high security padlock and two sentinel posts behind the new barrier would bring both access points to green.

### Pedestrian access point

Extending the earth bund a few meters each side to an opening of 1.5m would bring this access point to green.

### Metal post and rail sections

Constructing a low earth bund along this boundary and planting with wildflowers would bring the status of this boundary section to green.



## Horn Street

Horn Street recreation ground is located in Seabrook, on the eastern fringe of the town and predominately serves this area.

The recreational ground is flanked on all sides by established trees, hedging, residential housing and a stream. The boundary abutting an access track is also planted with established trees and hedging so has been marked as green apart from two sections either side of the metal horse accessible barrier. This leaves two access points, the first access point is secured with a metal horse accessible barrier however this is only locked in place with un-shrouded padlock and the second access point is a pedestrian access. The vehicle access point has been flagged as red and the pedestrian access point as well as either side of the metal horse accessible barrier have been flagged as amber.

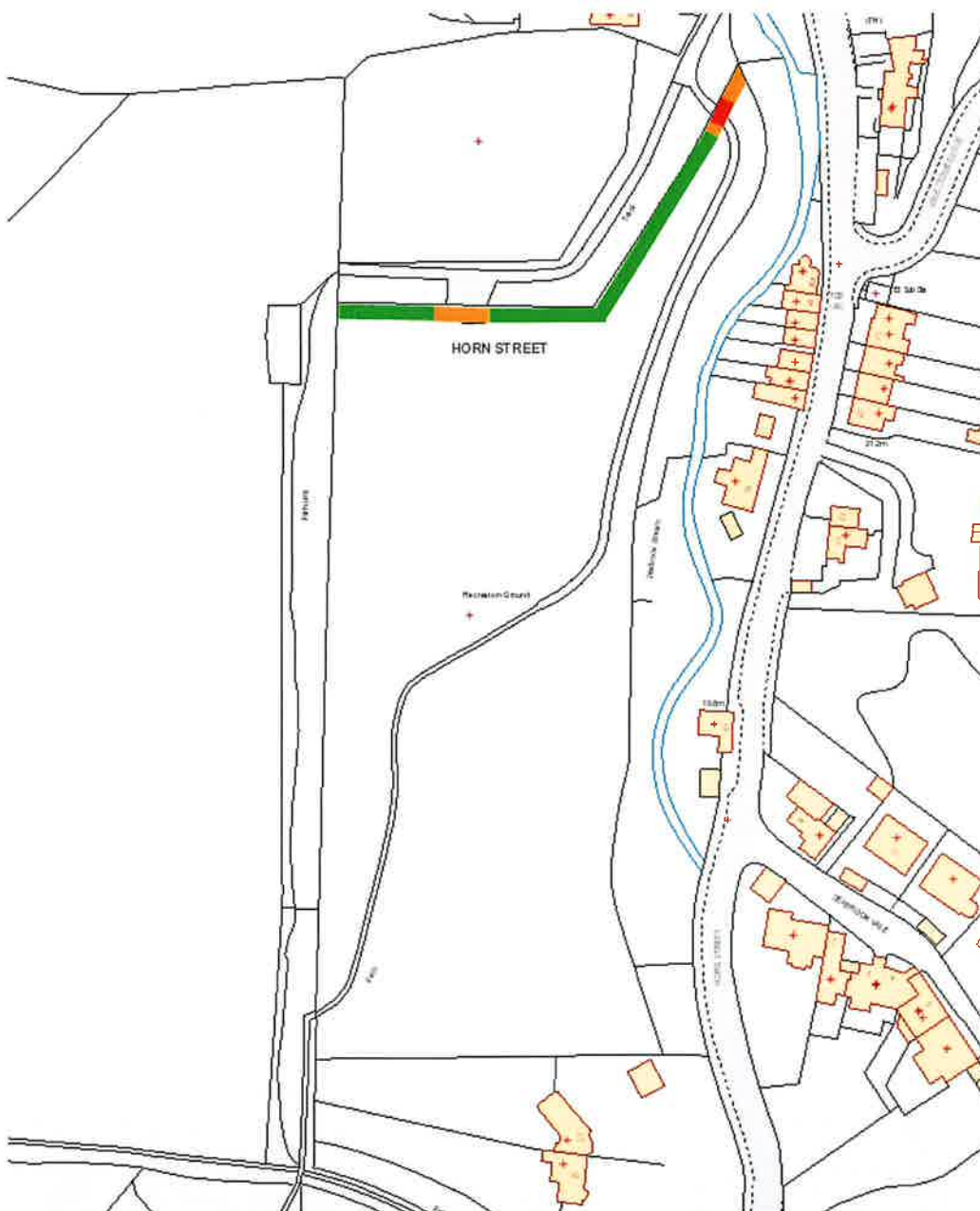

**Current estimated penetration time – 1 minute using bolt croppers.**

## **Recommendations**

### Existing metal horse accessible barrier

Either installing a new barrier with a shroud protecting a high security padlock or installing two sentinel posts behind existing barrier would bring the status of this access point to amber.

Installing both a new barrier with a shroud protecting a high security padlock and two sentinel posts behind the new barrier would bring this access point to green.

### Pedestrian access point

Constructing an earth bund a few meters each side leaving an opening of 1.5m would bring this access point to green.

### Either side of metal horse accessible barrier

Constructing an earth bund a few meters each side would bring these sections to green.